

MUKHRINO FIELD STATION FACILITIES PLAN (INFRASTRUCTURE AND BUILDINGS POSITION, PLANS OF CONSTRUCTIONS)

1. Location of building and infrastructure of Mukhrino accommodation/lab work zone.

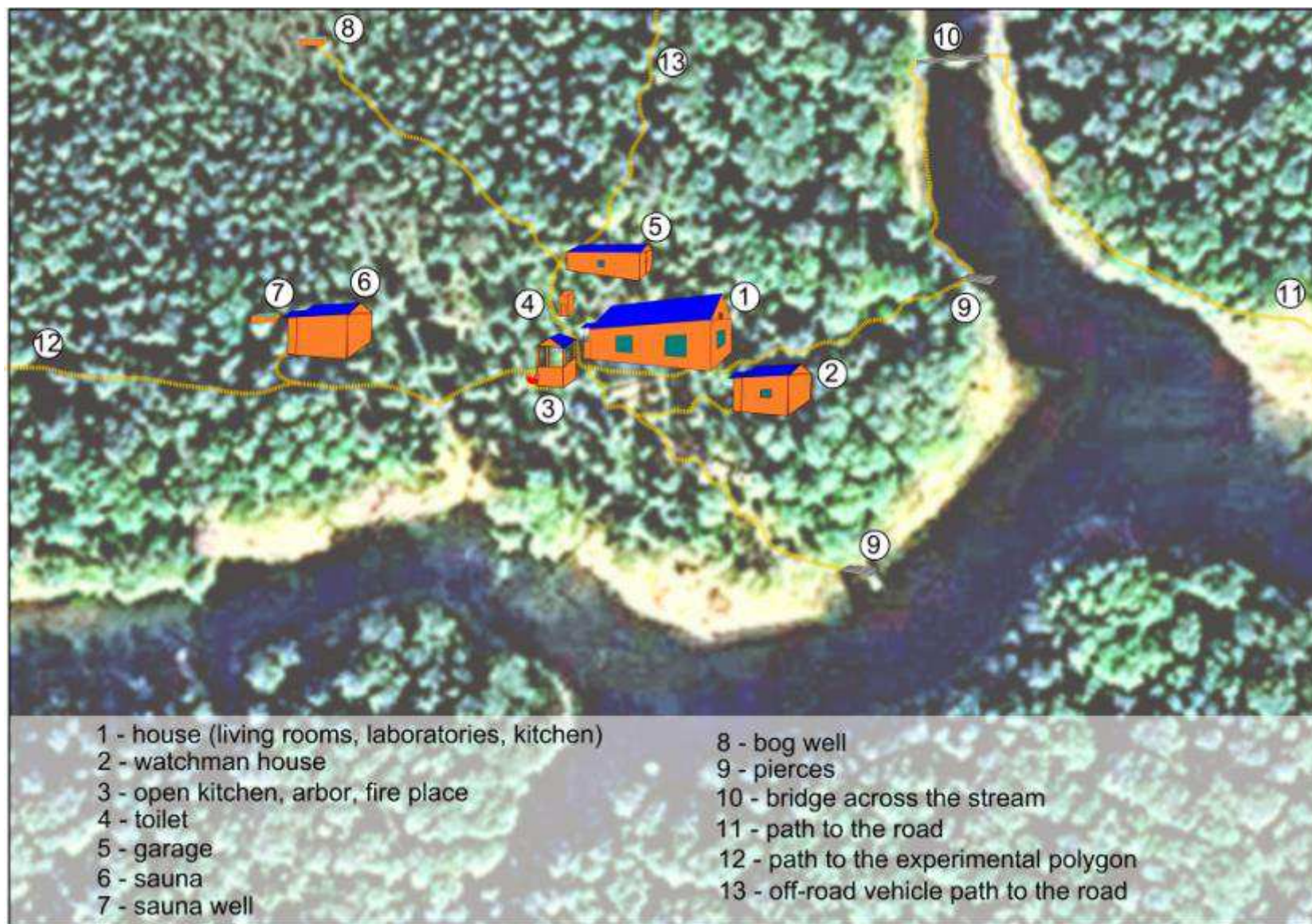

2. Plan of construction of **1st room** (10 x 5 m.), designed for **accommodation and work** in summer time (5 bed places); for kitchen, accommodation and work in winter time. The room is heated by wood burning stove.

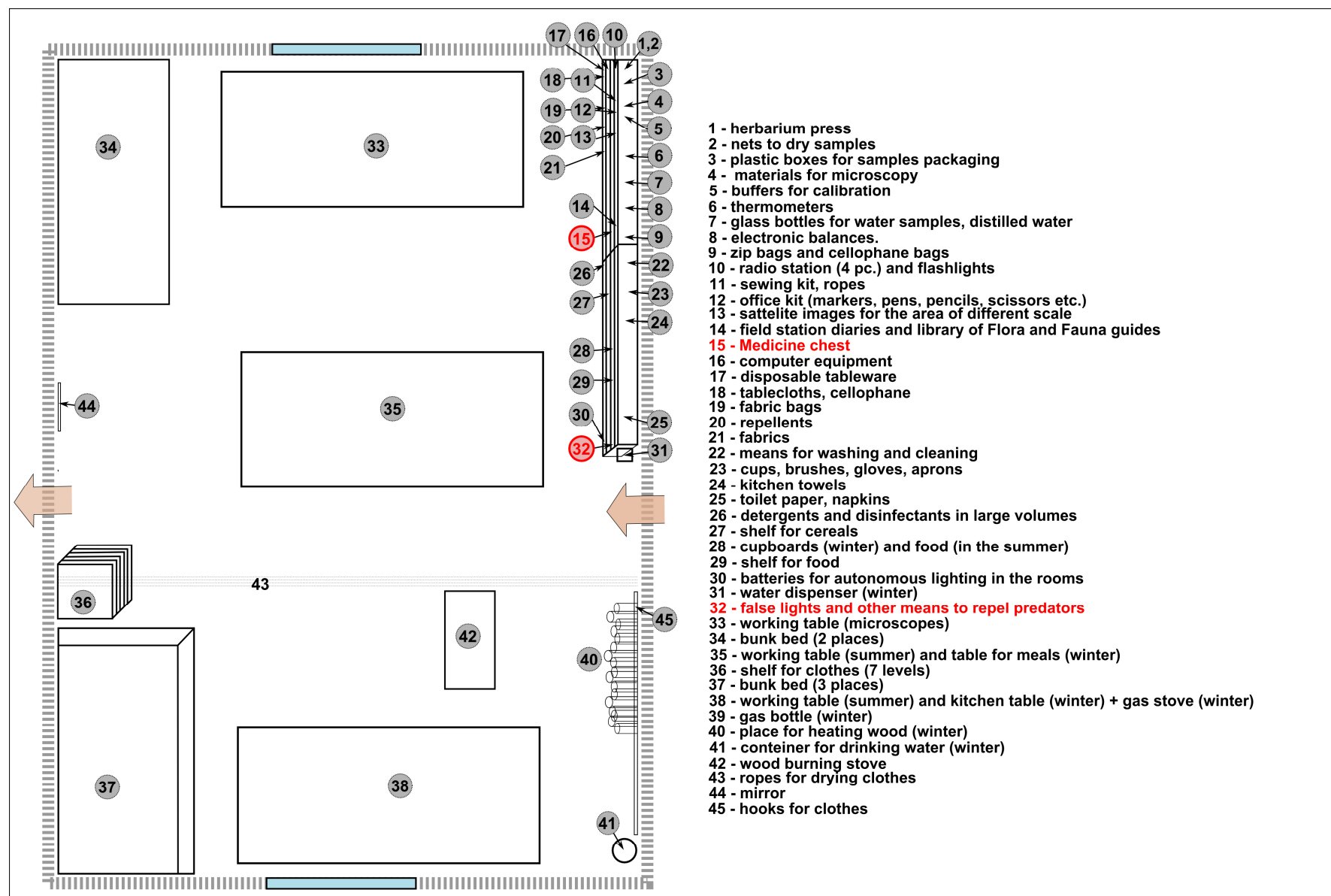

3. Plan of construction of **2nd room** (10 x 5 m.), designed for **accommodation and work** in summer and winter time (9 bed places); in winter the room could be heated according to needs by wood burning heater.

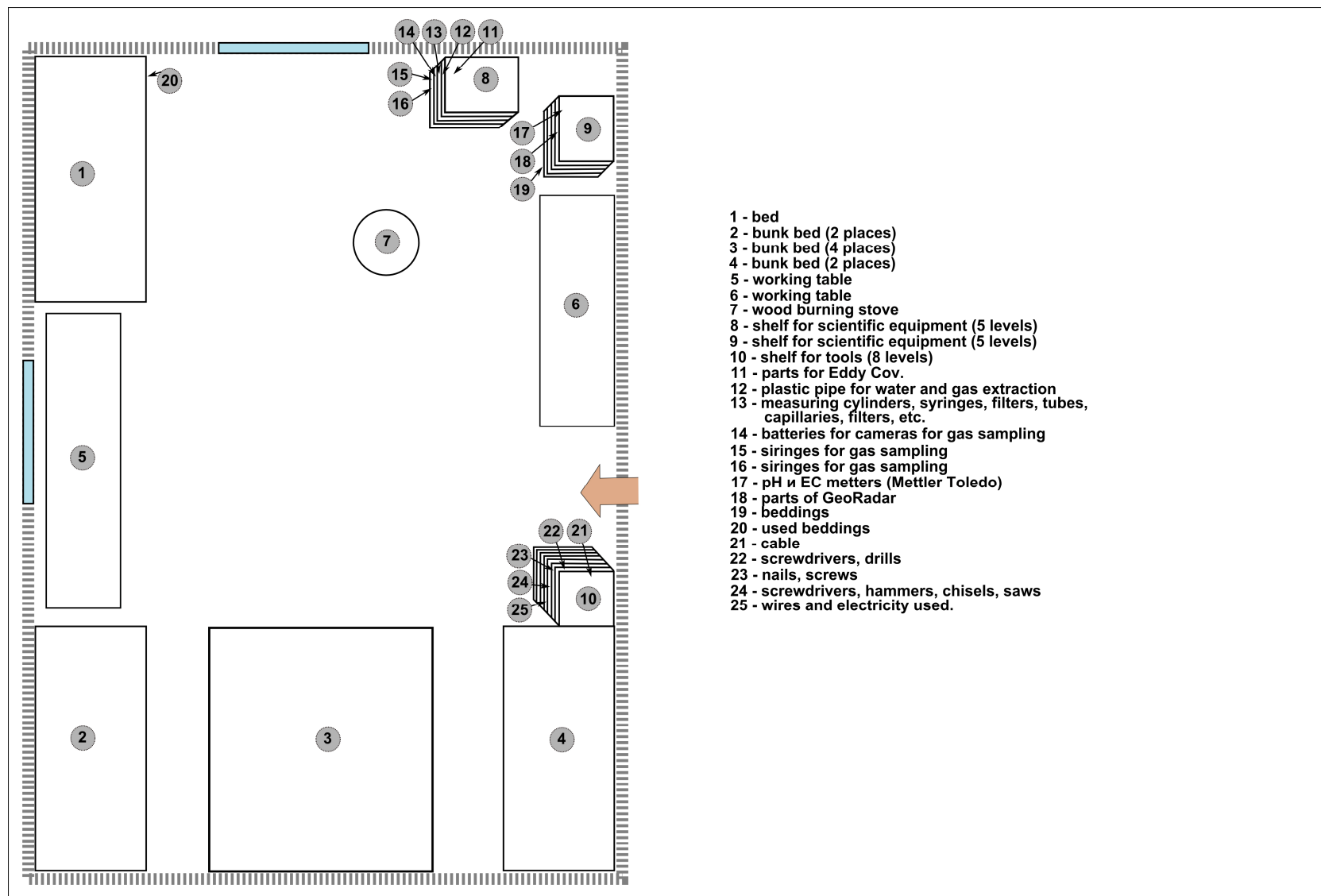

- 1 - bed
- 2 - bunk bed (2 places)
- 3 - bunk bed (4 places)
- 4 - bunk bed (2 places)
- 5 - working table
- 6 - working table
- 7 - wood burning stove
- 8 - shelf for scientific equipment (5 levels)
- 9 - shelf for scientific equipment (5 levels)
- 10 - shelf for tools (8 levels)
- 11 - parts for Eddy Cov.
- 12 - plastic pipe for water and gas extraction
- 13 - measuring cylinders, syringes, filters, tubes, capillaries, filters, etc.
- 14 - batteries for cameras for gas sampling
- 15 - syringes for gas sampling
- 16 - syringes for gas sampling
- 17 - pH и EC meters (Mettler Toledo)
- 18 - parts of GeoRadar
- 19 - beddings
- 20 - used beddings
- 21 - cable
- 22 - screwdrivers, drills
- 23 - nails, screws
- 24 - screwdrivers, hammers, chisels, saws
- 25 - wires and electricity used.

4. Plan of construction of second floor room, designed for **night accommodation** in warm season (8 bed places, 10 x 6 m) and for **storage of equipment and materials** .

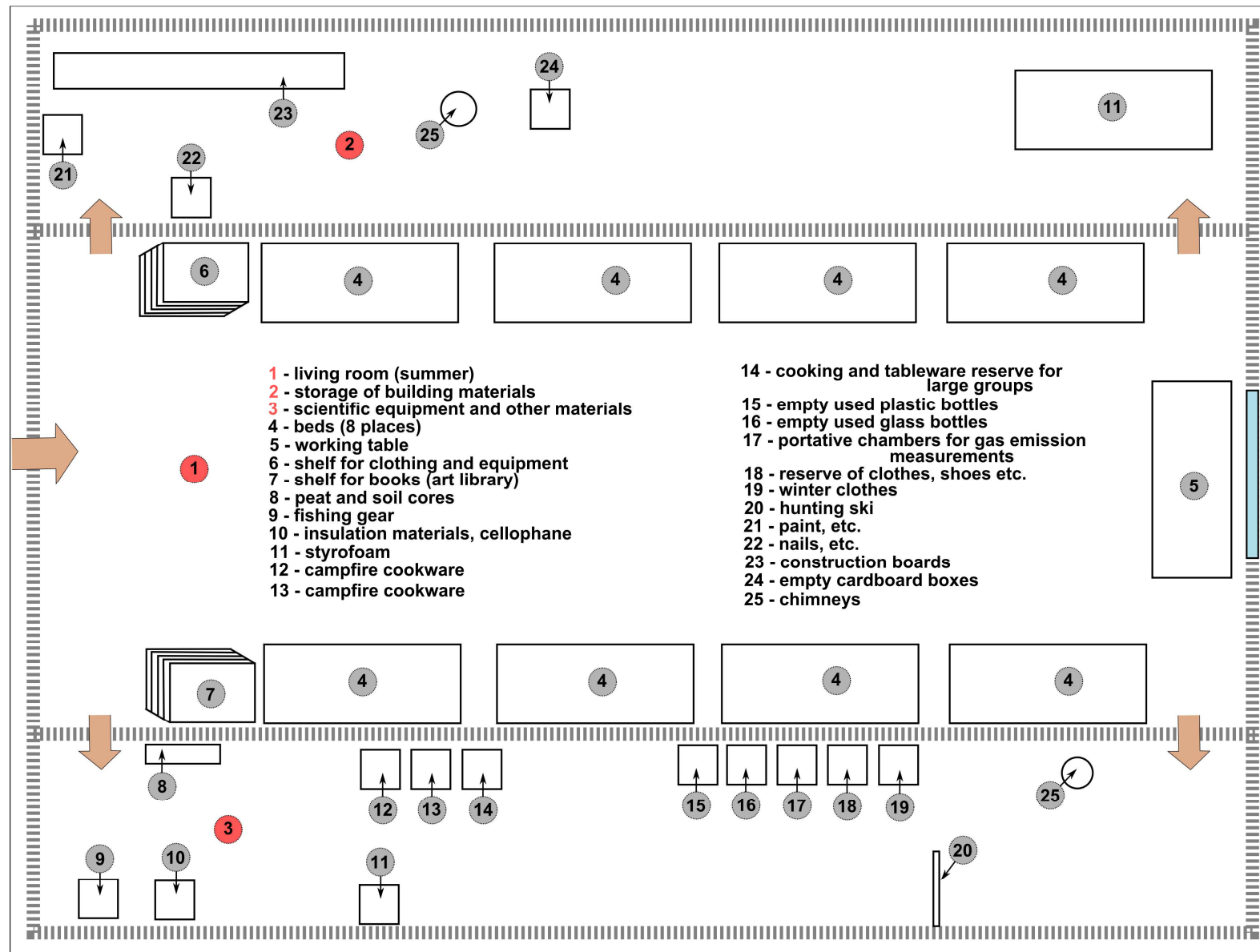

5. Plan of construction of **porch**, equipped for **cooking and dining** in warm season (for approximately 20 person) and for **evening meetings** (10 x 3.5 m).

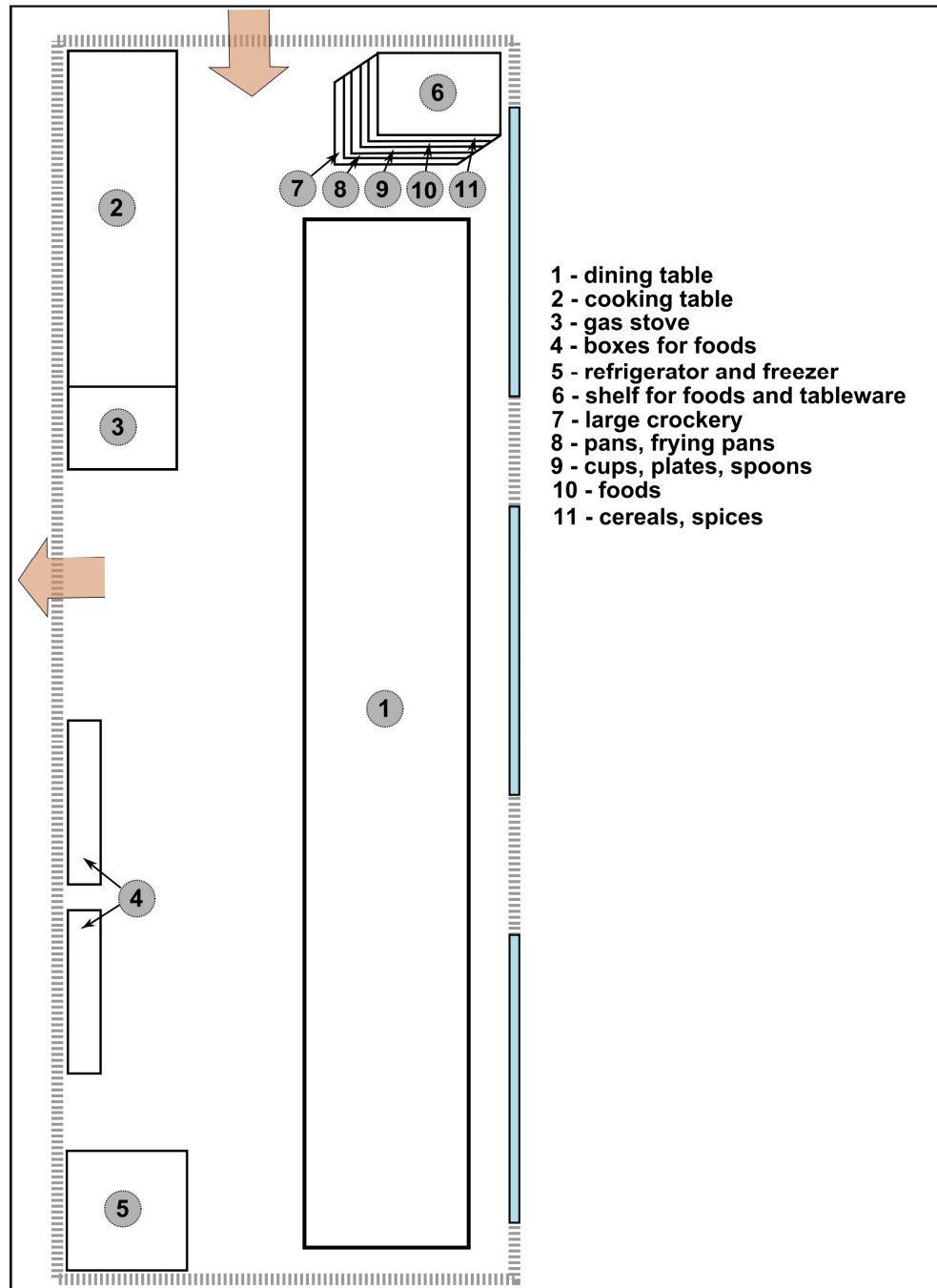

6. Plan of construction of **watch man house** (one room with one bed, heated by wood burning stove) (4 x 4 m).

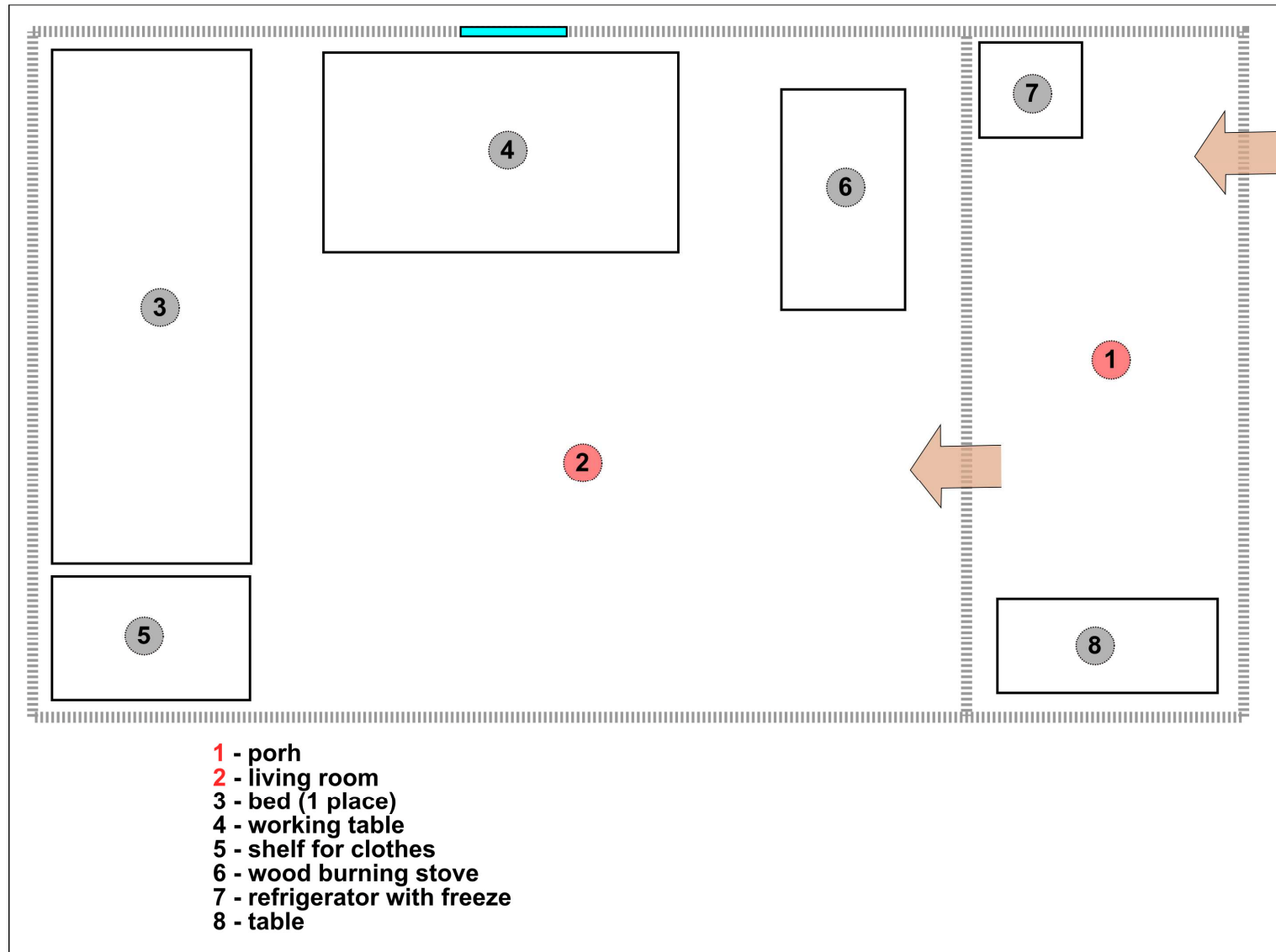

7. Plan of construction of **Russian sauna** (banya) (4 x 4 m).

